



SV

Flow Control Valve

SV Series

Flow Control Valve

AKME
SOLUÇÕES EM AUTOMAÇÃO



Ordering Code

SV

Series Code

SV: Precision Flow Control Valve

01

Port Size

01: G1/8"

02: G1/4"

03: G3/8"

04: G1/2"

Symbol

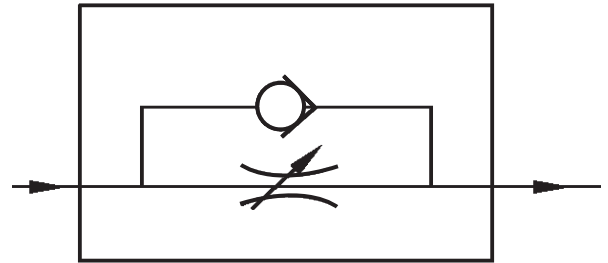

Specification

Model	Accurate Type			
	SV-01	SV-02	SV-03	SV-04
Port Size	G1/8"	G1/4"	G3/8"	G1/2"
Working Medium	Air			
Working Pressure	0 ~ 9,5 Bar			
Ambient Temperature	-20 ~ 70°C			

SV Series

Flow Control Valve

Overall Dimension

SV Series

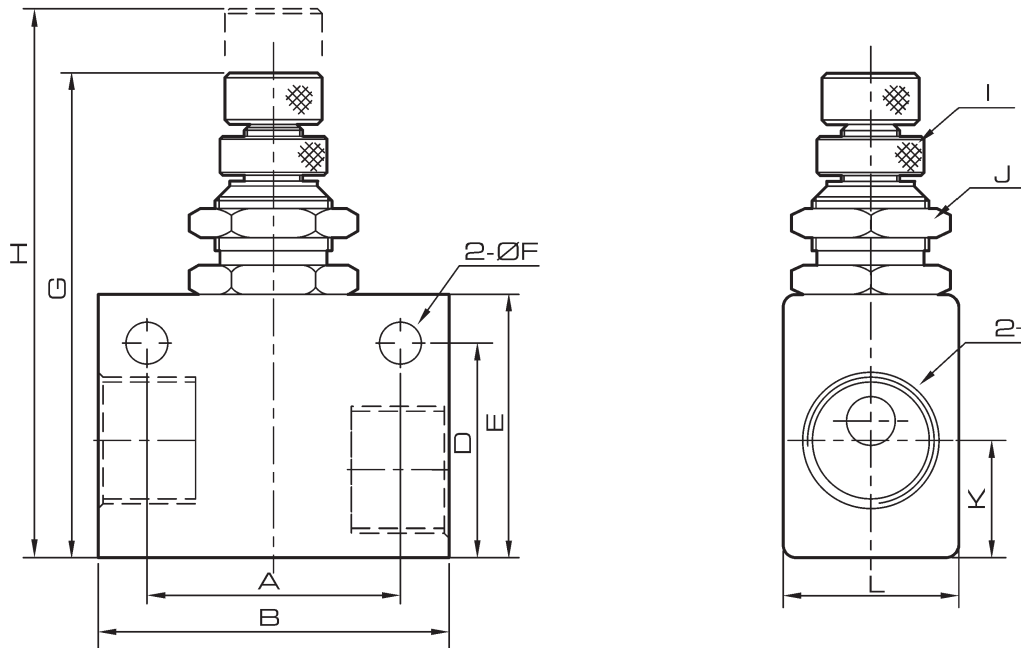

Dimension

Model Symbol	A	B	C	D	E	F	G	H	I	J	K	L
SV-01	22	32	G1/8	22	27	4.3	49.7	56.5	M6X0.5	M12X0.75	12	18
SV-02	26	36	G1/4	22	27	4.3	49.7	56.5	M6X0.5	M12X0.75	12	18
SV-03	28	40	G3/8	25	30	4.3	52.7	59.5	M6X0.5	M12X0.75	13	22
SV-04	28	40	G1/2	30	35	4.3	58.7	65.5	M6X0.5	M12X0.75	13.5	26